

A1 - Do Not Scale

Only PDF / DWG issues of this drawing are controlled.
All other formats (eg. DWG AutoCAD FILES) are UN-controlled and are used at your own risk.

This drawing is copyright ©.
It is sent to you in confidence and must not be copied, used or disclosed to any third parties without 3E permission.
It remains the property of 3E and must be returned on request.

Contractors should refer to the residual risks contained in the CDM Pre Construction Information before carrying out any site operations and should not issue parts of this drawing without including the CDM notes and references.
This information will include details of the SIGNIFICANT risks which 3E have considered beyond that which a competent contractor should be aware.

HEALTH & SAFETY
1. CONTRACTOR SHOULD BE AWARE OF GENERAL CONSTRUCTION RISKS TO PREVENT SLIPS, TRIPS AND FALLS AND TAKE NECESSARY PRECAUTIONS WITHOUT SPECIAL INSTRUCTION.

ROADS & DRAINAGE
2. CONTRACTOR TO PROVIDE TRENCH SUPPORTS AS APPROPRIATE AND ENSURE THAT PLANT REMAINS A SAFE DISTANCE FROM TRENCHES PRIOR TO INSTALLING DRAINAGE.
3. THE TIME THAT EXCAVATIONS ARE OPEN ON SITE SHOULD BE KEPT TO A MINIMUM AND ALL TRENCHES SHOULD BE SURROUNDED BY A BARRIER.
4. CONNECTIONS TO EXISTING SEWERS TO BE MADE BY NWL APPROVED CONTRACTOR ONLY.

5. CONTRACTOR TO MAKE OPERATIVES AWARE OF ASSOCIATED DANGERS TO HEALTH SUCH AS LEPTOSPIROSIS (WELLS DISEASE) AND RECOMMENDED PRECAUTIONS. ADEQUATE WELFARE FACILITIES AND PROTECTIVE CLOTHING TO BE PROVIDED AS REQUIRED.
6. UNFINISHED MANHOLES MUST BE COVERED WITH LOAD BEARING MATERIALS AND SURROUNDED WITH BARRIER.

PIPES & CABLES
7. SERVICE RECORDS TO BE REFERRED TO PRIOR TO WORK COMMENCING. CONTRACTOR TO PROCEED WITH CAUTION AND SERVICES TO BE LOCATED BY HAND DIG AND PROTECTED ACCORDINGLY.

EXCAVATION/FILL
8. CONTRACTOR TO ENSURE RELEVANT MEASURES ARE TAKEN TO KEEP PLANT AND PEOPLE A SAFE DISTANCE FROM STEEP SLOPES DURING THE WORKS.
9. CONTRACTOR TO ENSURE THAT PROCEDURES ARE IN PLACE TO KEEP PEOPLE A SAFE DISTANCE FROM WORKING PLANT WHERE NECESSARY.
10. CONTRACTOR TO REFER TO GROUND INVESTIGATION REPORT FOR CONTAMINATION TESTS AND TO PROVIDE ADEQUATE WELFARE FACILITIES AND PROTECTIVE CLOTHING AS REQUIRED.

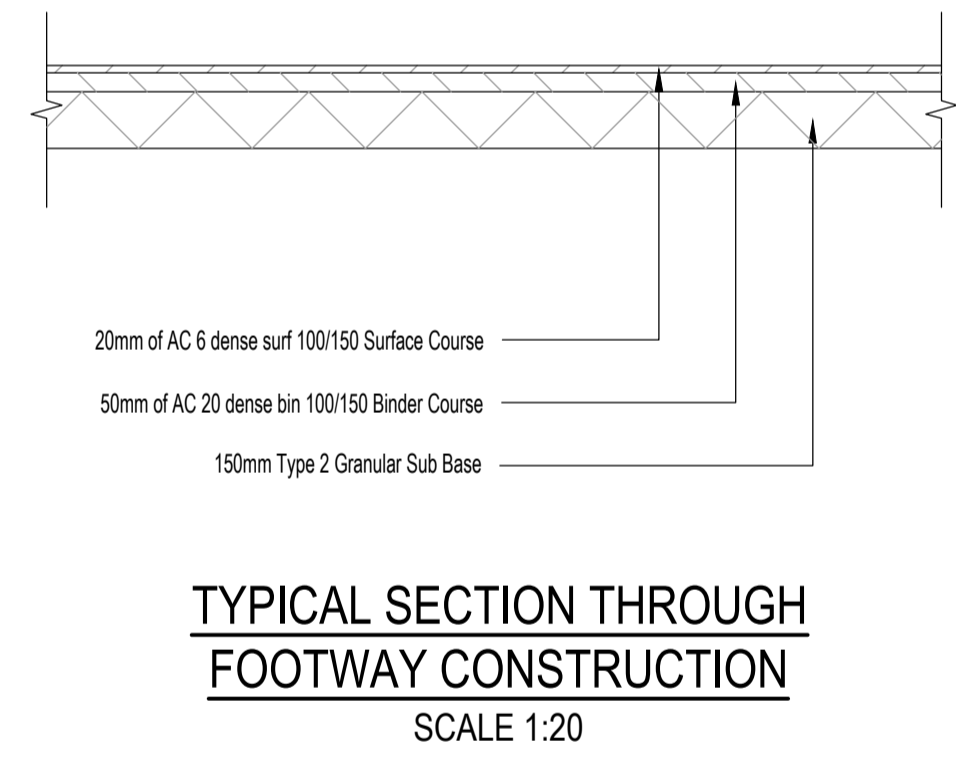
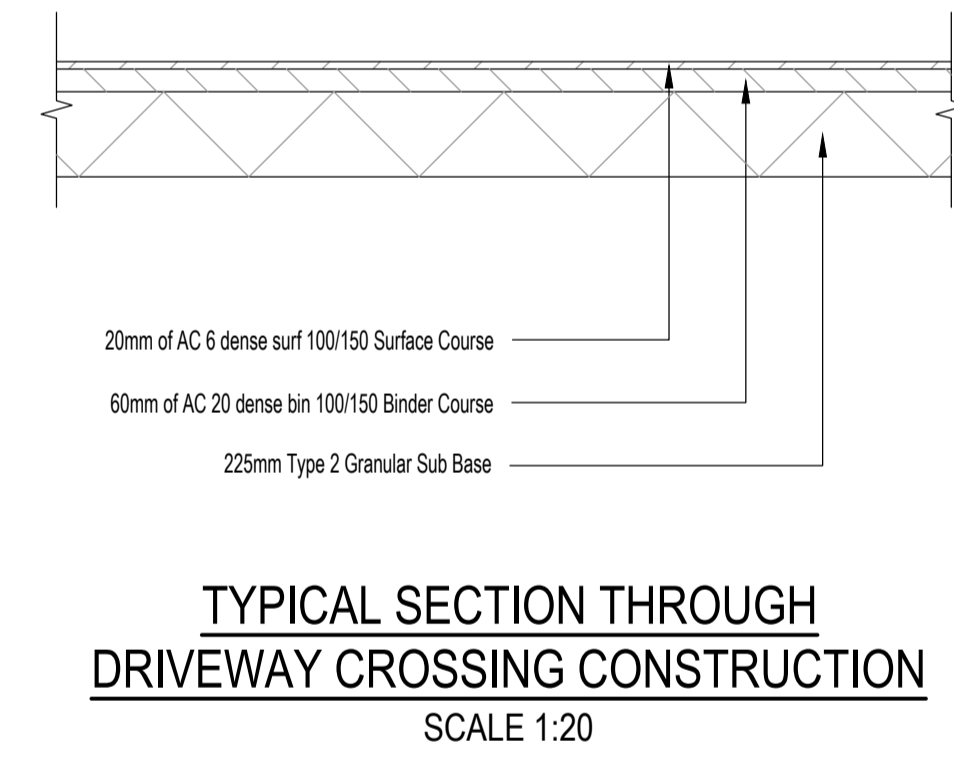
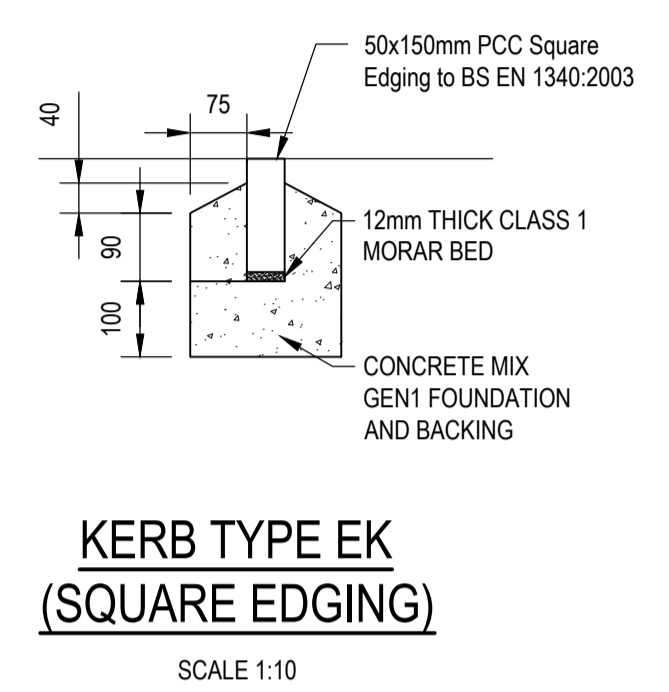
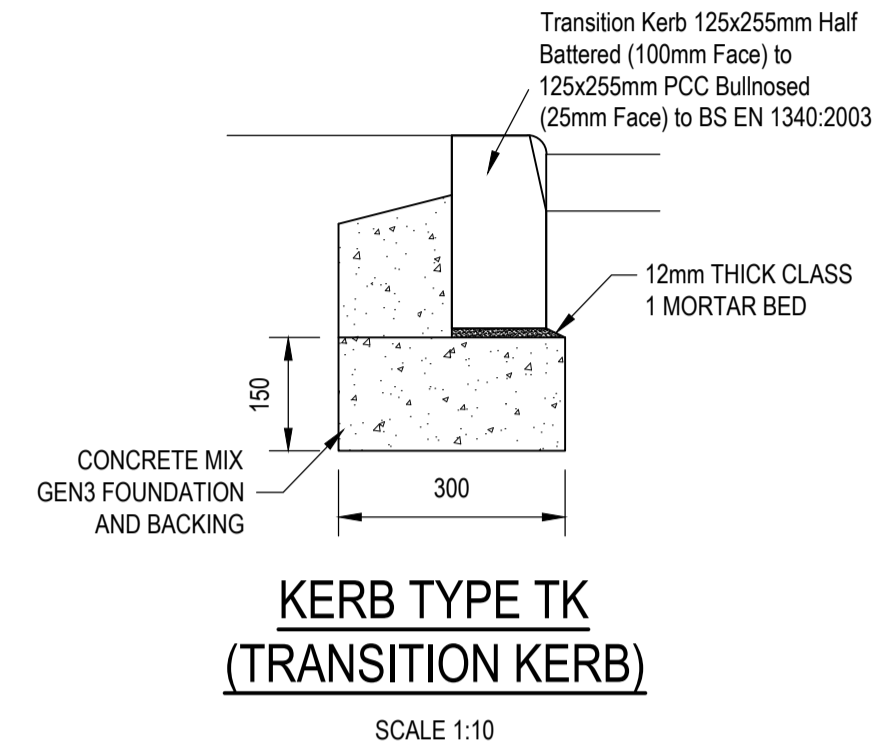
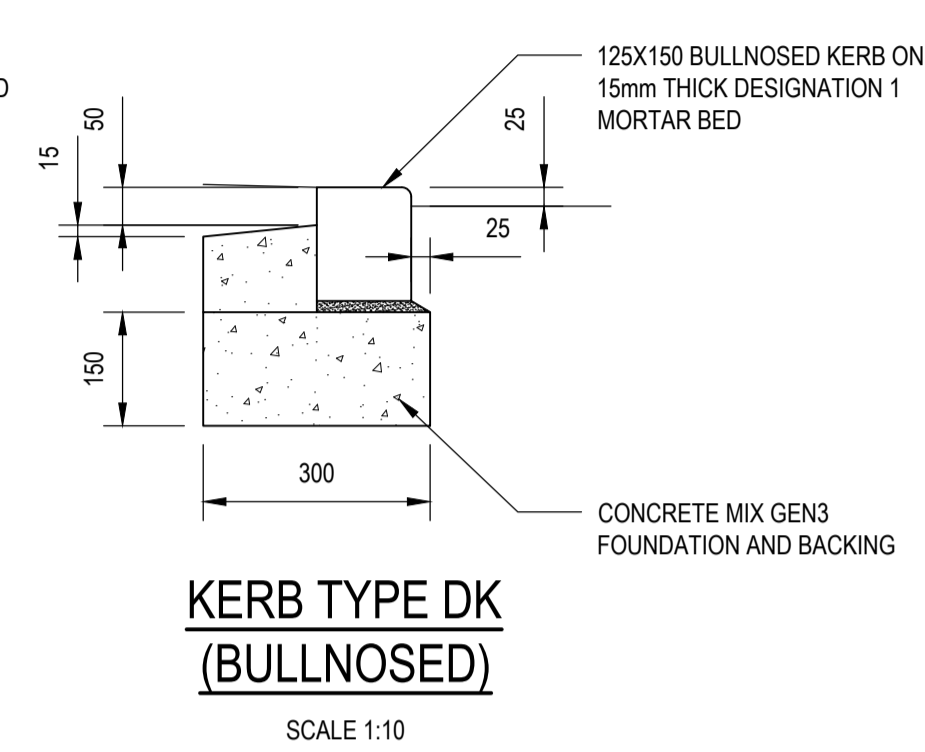
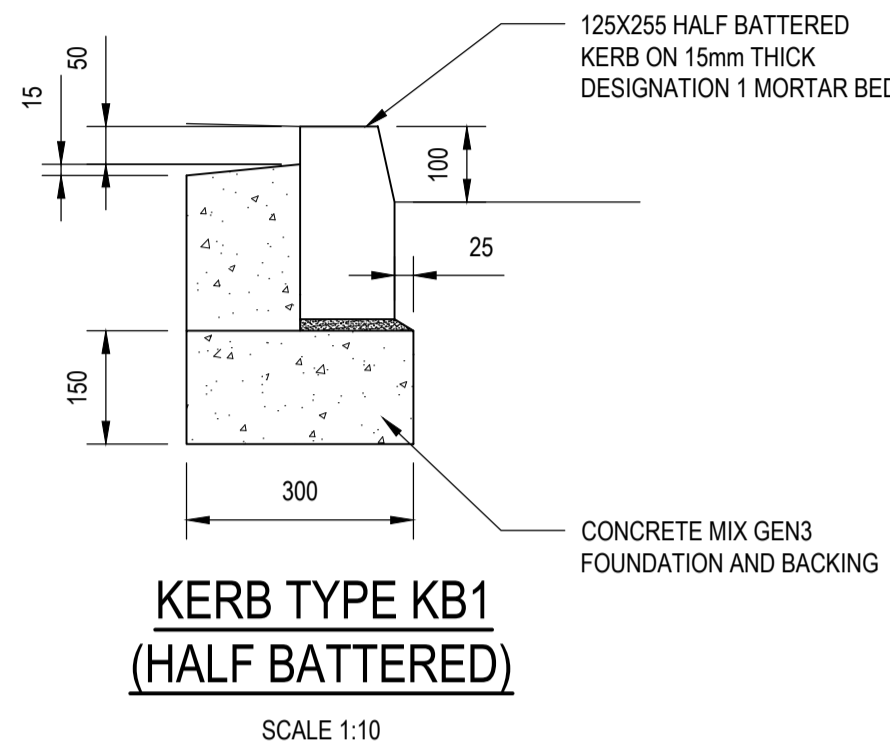

ALL CONSTRUCTION BUILD UPS ARE BASED ON 2.5% CBR AND SUBJECT TO INSITU CBR TESTS BEING UNDERTAKEN.

26/01/22	STEEL HOLES REMOVED FROM KERB BACKING	MP	T2
14/01/22	TENDER ISSUE	JF	T1
10/11/21	PRELIMINARY ISSUE	JF	P1
Date	Revisions	Drawn	Rev

TENDER

6 Benton Office Park
Bennett Ave,
Horbury,
Wakefield
t: 01924 240 420
wakefield@3econconsult.com

2 Esh Plaza
Sir Bobby Robson Way
Great Park
Newcastle upon Tyne
NE13 9BA
t: 0191 230 2993
newcastle@3econconsult.com

3E consulting engineers
www.3econconsult.com

WW Devonshire,
6 Devonshire Square
London
EC2M 4PL
t: 07500 121 181
london@3econconsult.com

Client NEW TYNE WEST DEVELOPMENTS			
Project SCOTSWOOD PHASE 5			
Title SECTION 278 WORKS BUILD UPS AND KERBS CONSTRUCTION DETAILS			
Scale	Author	Checked	Date
VARIES	JF	MP	NOV 21
Job Number	Originator	Zone	Level
Type			
Role			
Drawing No.			
Rev			
P19-401-3E-ZZ-XX-DR-C-4501-T2			